

Kit 8

For further information visit:
support.lampspares.co.uk
Search for IS08 in the search box.

Ref:
IS-08

Kit Contains:

1x BC Lampholder
1x Cable Cord Set
1x Wood Nipple
1x Cord grip
2x Wood Screws

Before you start please ensure you are competent to carry out electrical works and ensure the electricity is turned off.

If in any doubt stop what you're doing and seek professional advice.

Step 1: Drill an approx. 8mm hole in your wooden lamp, depending on the wood you may need to drill slightly bigger or smaller (Please start smaller and work your way up if needed)

Step 2: Separate the Lampholder into it's 3 sections, take the bottom section and loosen the locking screw on the inside.

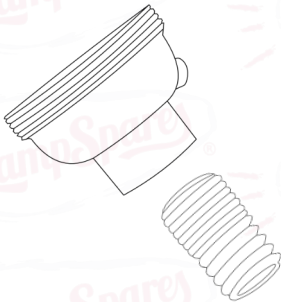
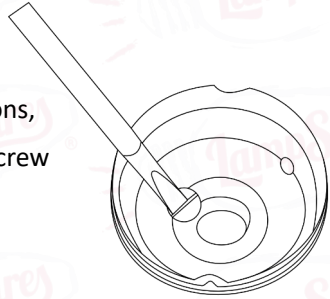

Step 3: Take the wood nipple and screw it into The Bottom section of the lampholder. Then tighten the silver screw inside the Lampholder bottom section.

Step 4: Using the bottom section of the Lampholder as a grip, thread the wood nipple into the lamp base (**Do not use any grips or pliers as it will damage the Lampholder**)

Step 5: Once installed, feed the cable up and through your base.

Step 6: Take a pair of pliers and double over the ends of the wires.

Then connect the wires to the connection unit of the lampholder, as shown below (**Fig 1**).

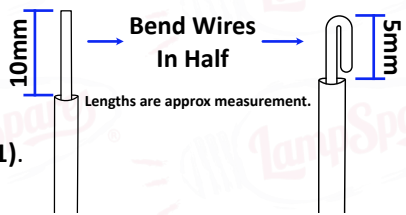

**Ensuring that the wires do not stick too far through the connection unit.
(If they do, then the light bulb may short out, and it will blow the fuse)**

Step 7: Carefully push the connection unit into the bottom section of the lampholder, ensuring the alignment is correct, as shown below (**Fig 2**).

Step 8: Screw the top section of the Lampholder onto the Lampholder's bottom section, ensuring the alignment is correct (**Fig 3**).

Step 9: To finish off the installation, take the cord grip and fix it underneath the lamp base to prevent the cable from being pulled out of the lampholder.

If the kit is not working, please see below and ensure your lampholder is aligned correctly.

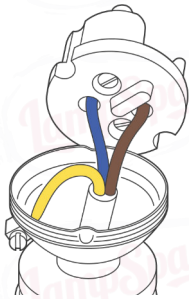

Fig 1

The indents on all 3 parts must align.

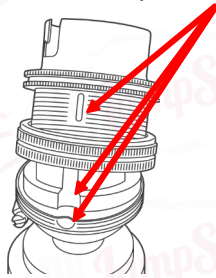

Fig 2

After installing, look down on the lampholder. The pins and notches should be as shown below.

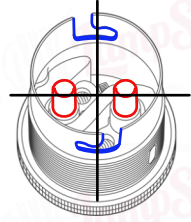

Fig 3

If you have any concerns or difficulties in connecting this product please contact us, details at the bottom of this guide.

All electrical parts confirm to BS standards and have full CE approval, please email for copies.



Unit 3 Brookside Business Park | Brookside Avenue | Rustington | West Sussex | BN16 3LP

T: 01903 776644 | KB: support.lampspares.co.uk

© Lampspares. All Rights Reserved

Rev: 01-A - 12/03/2024